

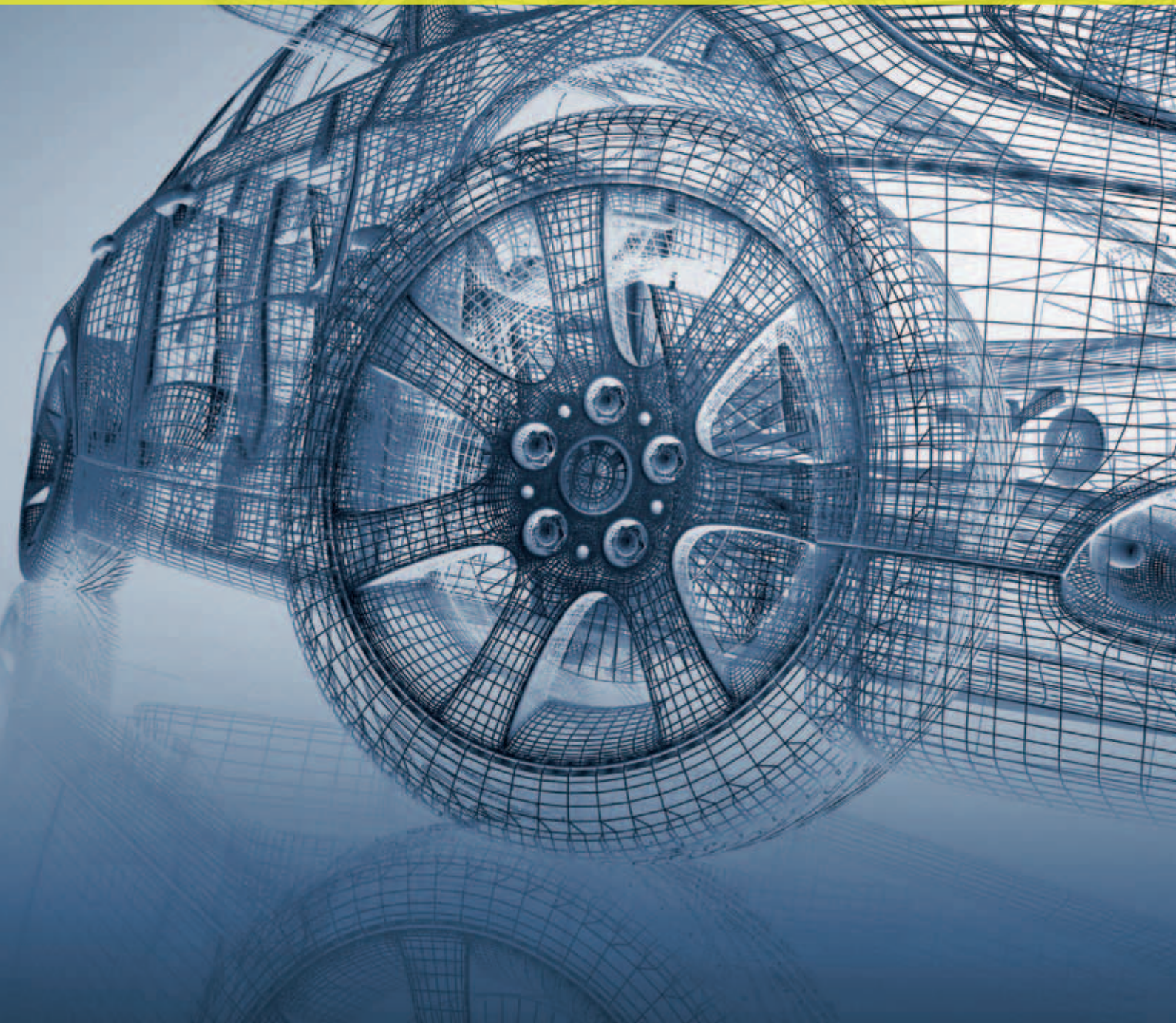

CAD INTEROPERABILITY SOFTWARE SUITE



3D_Evolution® Feature Based technology converts 100% workable, fully functional CAD models, maintaining features, parameters, PMI and metadata.

THE FUTURE OF INTEROPERABILITY

Today, companies are looking for interoperability that goes beyond the need for CAD translations in a boundary representation (B-Rep) of 3-D models. Our innovative Feature Based technology gives companies the freedom to optimize human resources within MCAD environments and to convert legacy data without losing product knowledge and time.

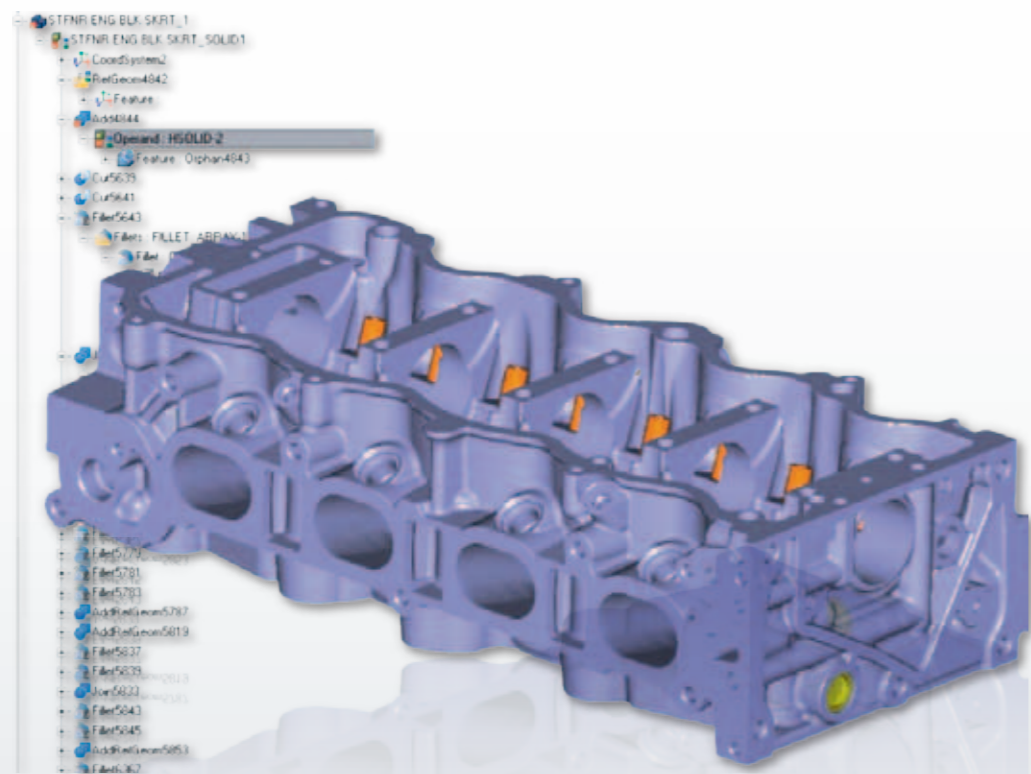

INDEPENDENT INTERFACES

Our native interfaces extract the history, features and related parameters directly from the binary file, without requiring access to a license or the API of the original CAD system. By importing CAD data directly, the entire information necessary can be retrieved extremely fast and without any limiting factors.

ADAPTIVE REMASTERING

3D_Evolution® Feature Based performs an adaptive optimization of the model's history taking full account of the feature types and the data structure of the target system.

Plug-ins available for major CAD systems are automatically remastering the adapted Feature Based models, maintaining assembly structure, features and related parameters, PMI and metadata as well as B-Rep geometries.

If a parametric model contains skins for surface split operations or imported solids, our proven healing functions allow for a robust remastering of subsequent feature operations.

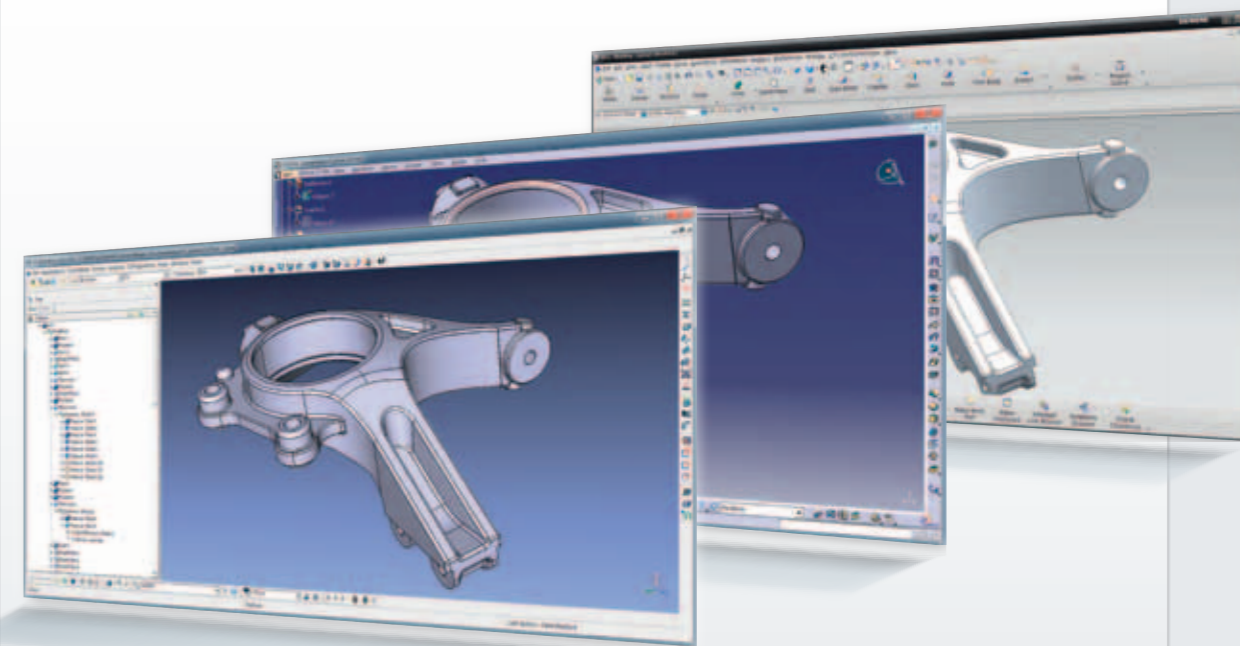

RELIABLE VALIDATION

After conversion, the shape of the original parts and assemblies can be compared with the converted models to validate the resulting geometries. If a difference is detected, the logfile lists the maximum deviation and the software creates a lightweight visualization displaying variances in detail.

Save your intellectual property though sharing 3-D data. Within seconds the Simplifier creates bounding geometry from parts and assemblies providing lightweight solid models.

IP PROTECTION AT THE PUSH OF A BUTTON

Within seconds, through a simple push of a button, the Simplifier creates bounding geometry from parts and assemblies. This technology is the most efficient IP protection for 3-D models available today. This unique technology also creates lightweight models used for digital mock-up and virtual reality applications in order to alleviate the handling of large assemblies.

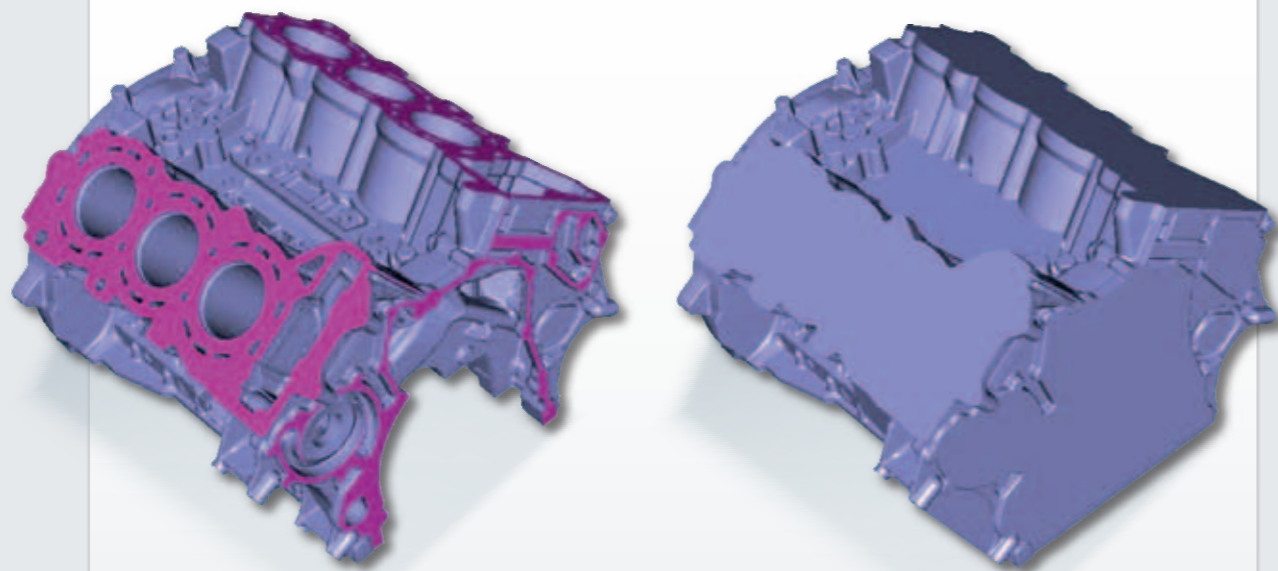

SOLID QUALITY

The Simplifier removes the interior geometry of a model providing perfect lightweight solids of the bounding geometry, easy to handle for further use in any CAX system. Simplified models can be converted to all B-Rep or tessellated formats available for 3D_Evolution®.

SIMPLIFIER DETAILS

Details, e.g. specific holes or other features that should be excluded from simplification, can be selected by the user before the process is being started.

Bodies can be deleted automatically by names, e.g. *DIN* or *M12*, listed in a text file. Also a minimum volume can be defined, bodies falling below this value will be deleted automatically during the process.

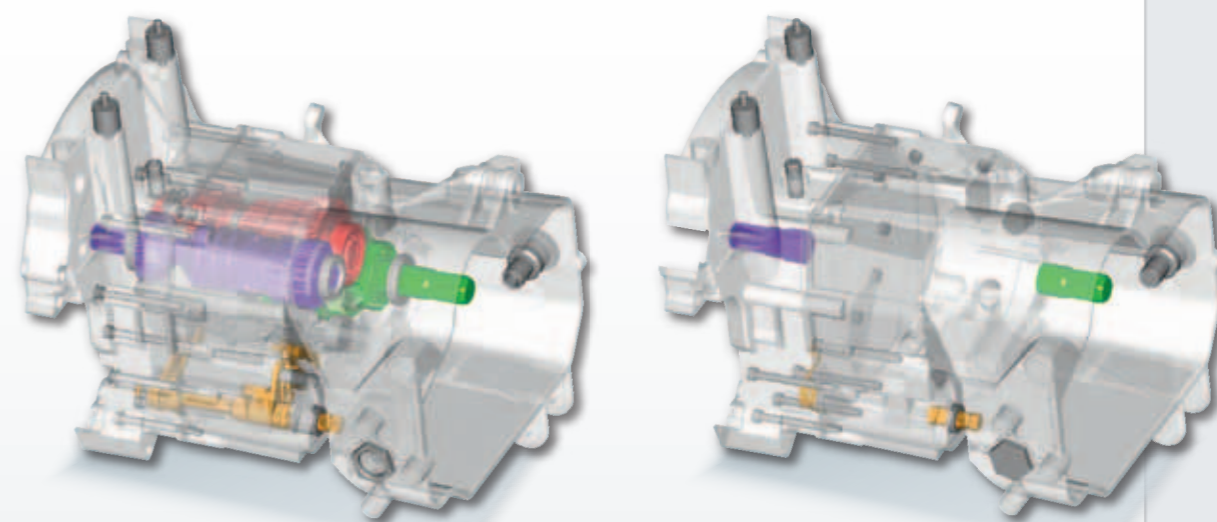

AUTOMATIC SIMPLIFICATION

The simplification process can also be executed fully automatic in batch mode controlled by the Enterprise Batch Manager. Using the batch mode, the Simplifier facilitates the automatic simplification of very large data volumes within the shortest of time.

By separate handling of the assembly and part files using distributed multiprocessor computation 3D_Evolution® reaches an unrivaled performance.

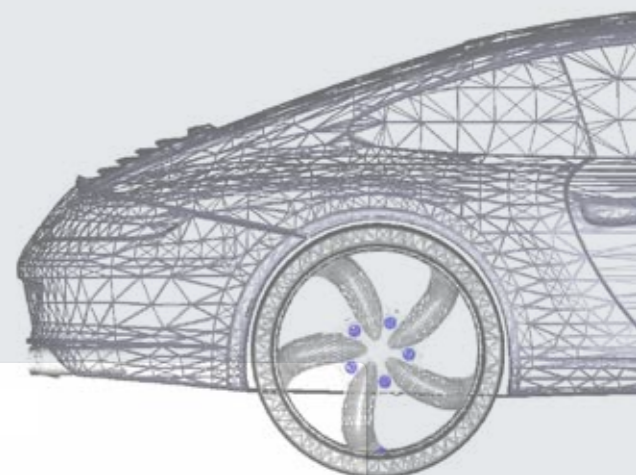

FEM Tools is bridging the gap between CAD and CAE with easy-to-use direct modeling, midface and defeaturing functions for a flexible and accelerated product development process.

INDEPENDENT QUALITY

Interfaces for all major formats are making CAE analysts independent from access to a CAD system. Check, healing and conversion functions assure perfect model quality, while easy-to-use manual functions are helping to repair even very difficult geometries – for a fast and focussed model clean-up.

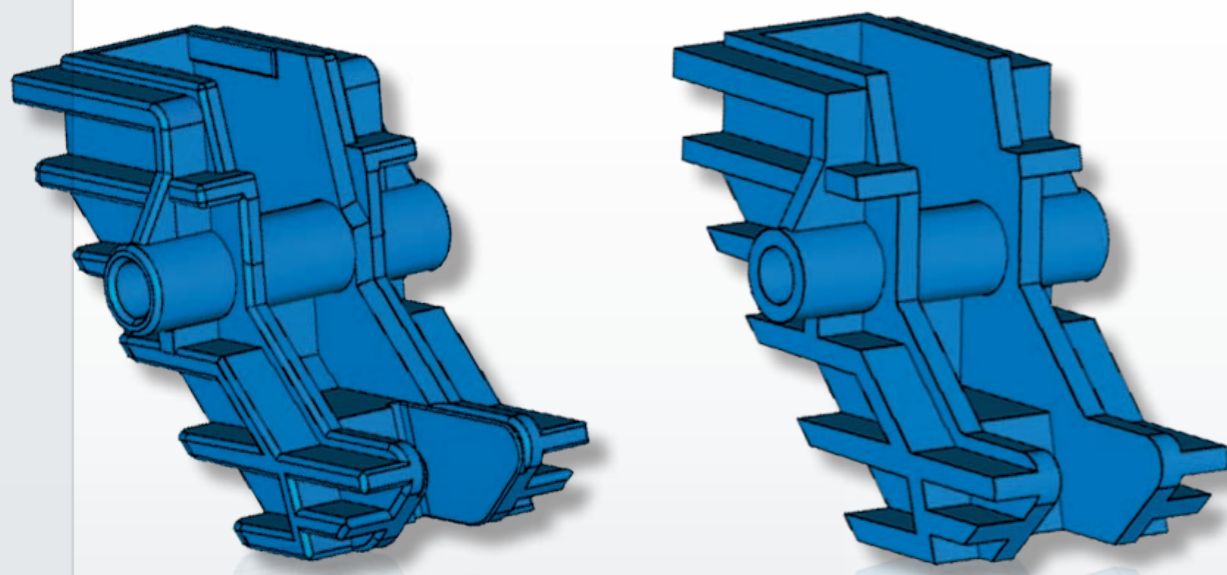

DEFEATURING AND DIRECT MODELING

Through intelligent defeaturing functions for geometry simplification, features such as holes, rounds, chamfers, letters and other details can be deleted within seconds and without specific CAD know-how. Robust direct modeling functions allow for an easy-to-use and reliable manipulation of geometry, to optimize models for CFD and CAE mesh generation.

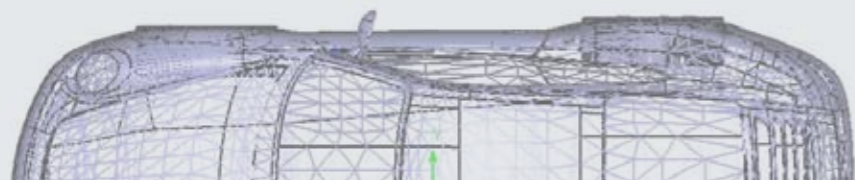

MIDFACE

This clever tool set creates midfaces from solid bodies and automatically trims the resulting faces for a connected high-quality sheet body. A wide range of semi-automatic functions efficiently reduces the time needed to create perfect midface models. Several parameters to limit the maximum wall thickness and draft angle are helping to automate the process. The wall thickness of the original solid is attached to the midface model and can be saved in FEA-specific formats such as Nastran.

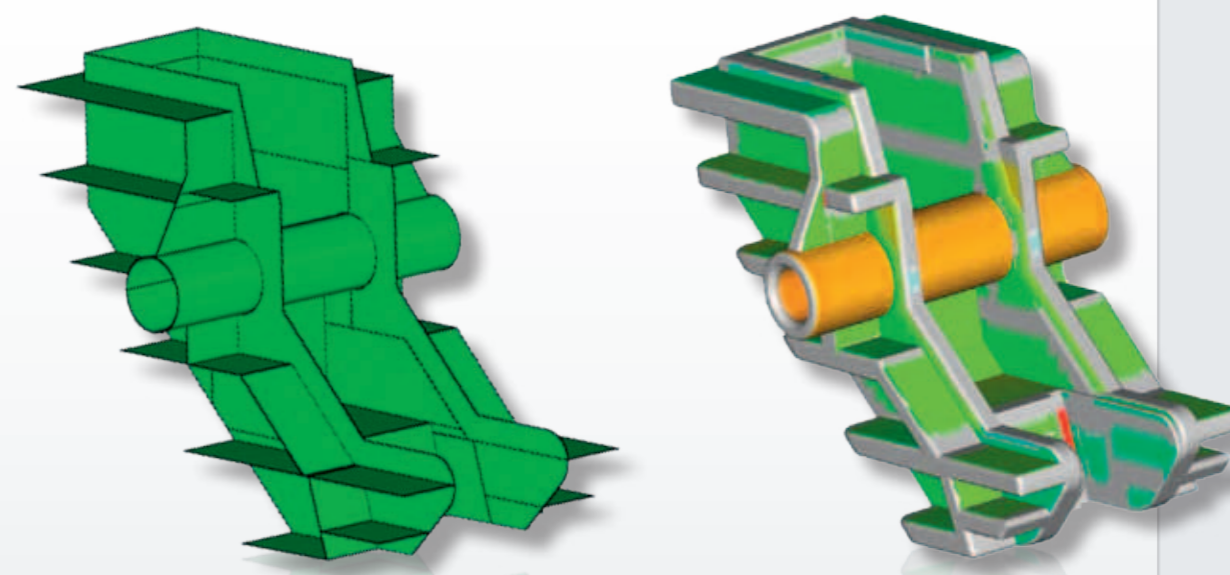

METAFACING MINIPATCHES

Minipatches and their basic surfaces can be merged by the Metacee function at the push of a button. Depending on the geometry, the elimination of minifaces is resulting in up to 75% lesser faces. Thanks to Metaface, geometry can now be meshed and handled easier for CFD and CAE calculations resulting from an efficient reduction of elements.



Advanced Analysis is easy-to-use and provides reliable results.

It works for all current CAD formats and allows a fast computation even for very large data volumes.

GEOMETRIC COMPARISON

Advanced Compare indicates and displays reliable and fast all variances between different 3-D geometries. Parts and assemblies of different formats can be compared with a user-defined accuracy. The powerful 3D_Evolution® graphics provides a clear overview. Discrepancies are highlighted with a colour scale, and filter functions allow for an easy interactive analysis. Not only geometric variances can be detected, but also separated assembly structure as well as PMIs can be compared. Performed in batch mode the Advanced Analysis functions create HTML logfiles and a lightweight viewer format as graphical output.

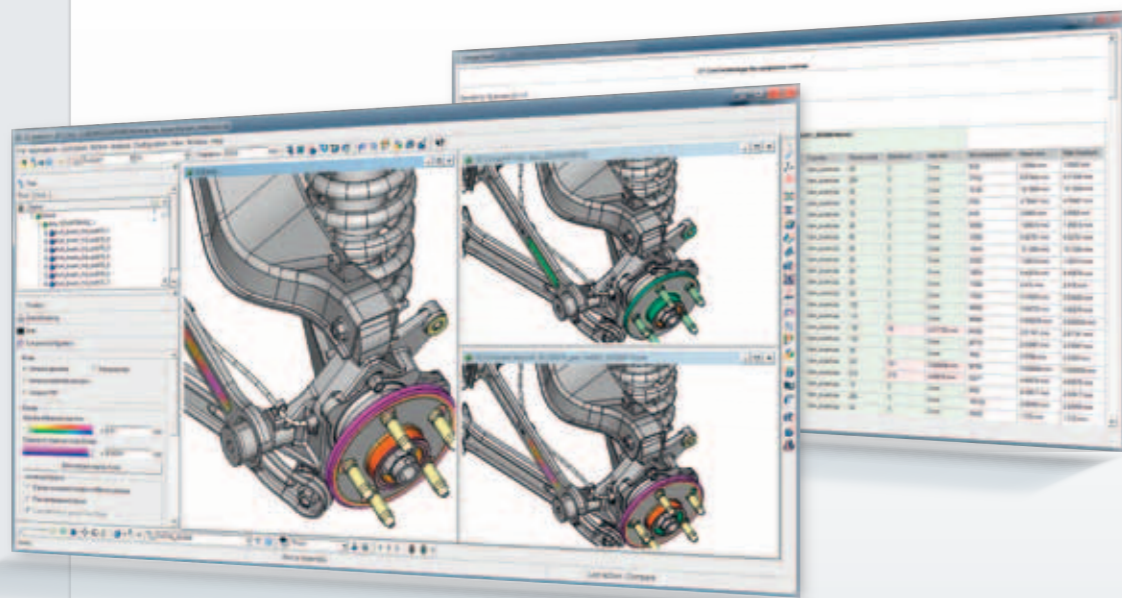

COLLISION DETECTION

For digital mock-up our reliable Collision Detection finds intersections between parts in assemblies. Parts with allowed intersections can be listed in a XML file and will then be excluded from the process. The detected collisions are highlighted by intersection curves while the model can be displayed transparent. The collision report file contains the list of collision partners as well as the related fully functional 3-D models and the collision curves.

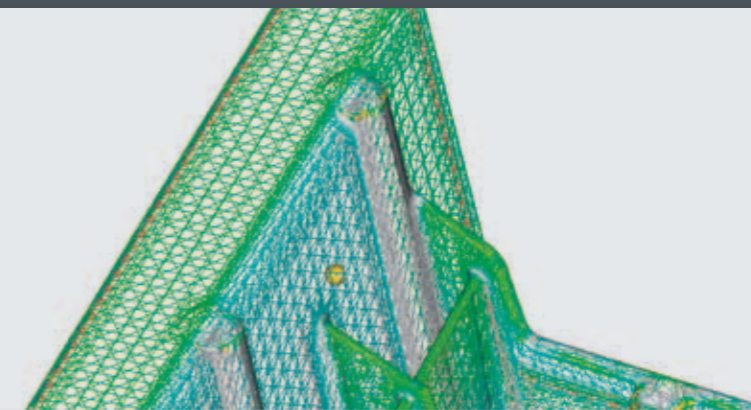

THICKNESS CHECKER

The Thickness Checker indicates areas of a critical, user-defined wall thickness, e.g. in casting parts. Areas where the wall thickness falls below or rises above the defined value are highlighted clearly and can be displayed separately while the values are indicated by colour. The Advanced Compare technology saves precious human resources, increases quality and avoids costly changes already at an early stage of the product development.

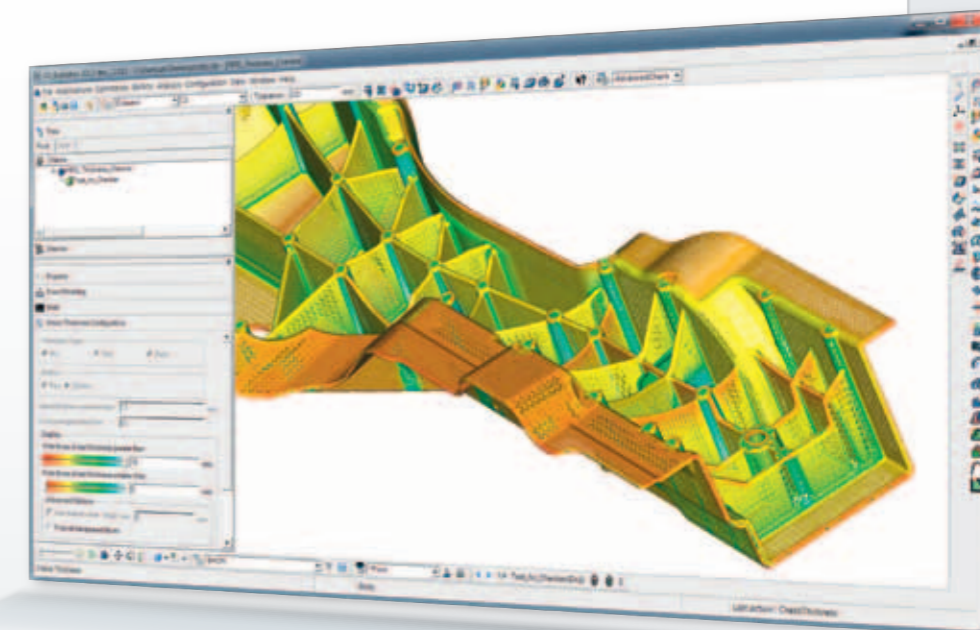

CLEARANCE CONTROL

This technology is important to assure the quality of assemblies, e.g. to avoid vibration noises caused by parts outside a defined clearance interval. A clearance can also be checked within parts to avoid design errors causing manufacturing problems. Reliability, high-resolution display as well as outstanding performance are shared between all Advanced Analysis modules.



ABOUT CORETECHNOLOGIE

Our mission is to optimize interoperability, helping organizations to efficiently share engineering data in the PLM process. Founded in 1998, CT CoreTechnologie consistently presents the most innovative developments and has shown an outstanding performance.

In the market we are recognized as reliable and fast reacting partner offering a wide range of sophisticated interoperability software solutions.

3D_Kernel_IO is also the core of our 3D_Evolution® suite which is the first-choice conversion tool of leading technology companies developing complex products in the automotive, aerospace, mechanical engineering and consumer goods industries.

Therefore, CoreTechnologie knows what counts in the CAD interoperability business and supports your needs. We understand that sometimes small details make a big difference. This is why we are also offering tailored solutions for our OEM customers.

Based on your specifications and our outstanding experience we develop customized interfaces and functions that meet all of your requirements perfectly. Using 3D_Kernel_IO, you benefit from well-established and mature products as well as the entire expertise and experience of the market leader for CAD interoperability solutions.



www.coretechnologie.com

CATIA® and SolidWorks® are registered Trademarks of Dassault Systèmes, SIEMENS PLM Software®, Robcad®, and Ideas® are registered Trademarks of SIEMENS, ProEngineer® is a registered Trademark of Parametric Technology Corporation

GERMANY

CT CoreTechnologie GmbH
Am Kreuzberg 7
D-63776 Mömbris
Tel: +49 (0) 6029 98 999 10
info@de.coretechnologie.com

FRANCE

CT CoreTechnologie Vente
Parc Techsud
12 rue du Professeur Jean Bernard
F-69007 Lyon
Tel: +33 (0) 4 78 61 79 42
info@fr.coretechnologie.com

JAPAN

CT CoreTechnologie Japan Office
〒100-0006
Tokyo Chiyoda-ku Yurakucho
1-6-3 Hibiya Eisen Bldg.
Tel: +81 (0) 3 3591 2619
info@jp.coretechnologie.com

U.S.A.

CT CoreTechnologies Inc.
63 Dixie Hwy
Rossford, OH 43460 U.S.A.
Tel: +1 (419) 662 7700
info@coretechnologies-inc.com

ITALY

Achelon Software House S.r.l.
12043 Canale (CN)
C.so Rodilhan, 23
info@achelon.it
www.achelon.it